 non-standard size customization

 OEM and ODM

 Professional strength factory





 Dimming
CCT 6500K

 2.4G remote
control

 Mobile
phone control



 Dimming
0%-100% light

 2.4G remote
control

 Mobile
phone control

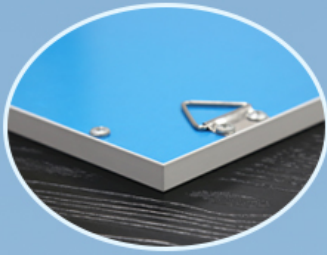
**Thickness:**

Thickness 11.5mm,
IP30 for choice

**Wire:**

Black: DC24V
White: cold color
Yellow: warm color
Red: red color
Green: green color
Blue: blue color

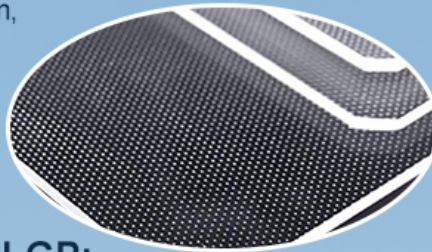
**LGP:**

PMMA material, 3mm thickness,
designed for 20 years using.

**Frame:**

Thickened 6063 aluminum,
seamless welding. Surface
spraying, comply with ISO 9001:2016

**Leds:**

Taiwan EPISTRA SMD3030+SMD3528
0.2/0.5W CRI>80,90,95 for choice
Single leds brightness 50-55lm

Composition material

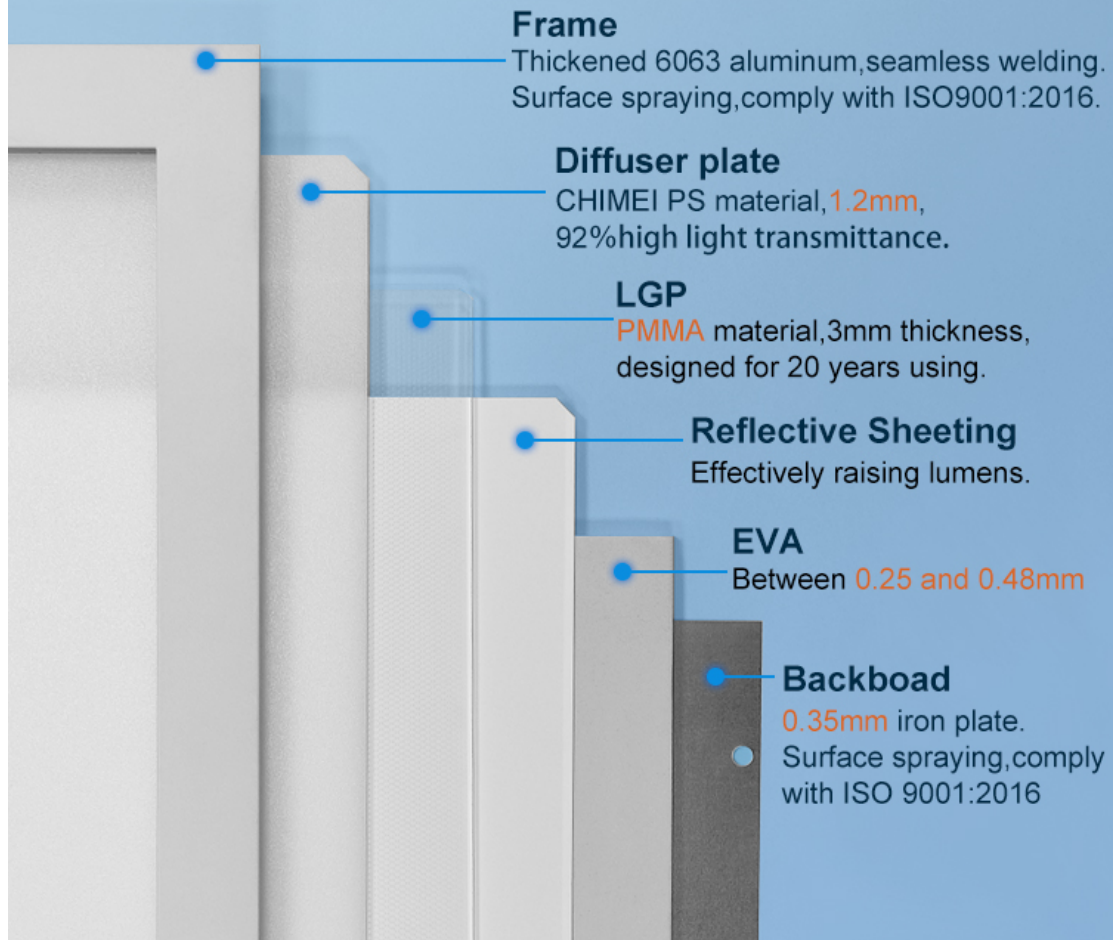

Hanging on the ceiling

Step 1

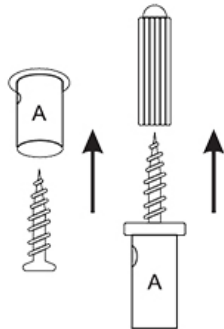

1. Install the A connector into the ceiling

Step 2



2. Put the string in the B connector and then combine with A connector.

3. Install the rope on the ceiling according to the dimension of the LED panel light.

Step 3

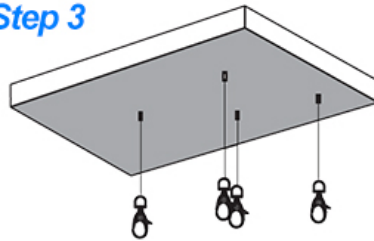

Step 4

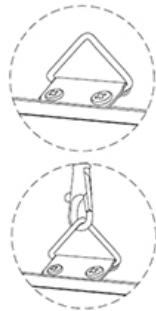

4. Connect the rope and the hook.

Step 5

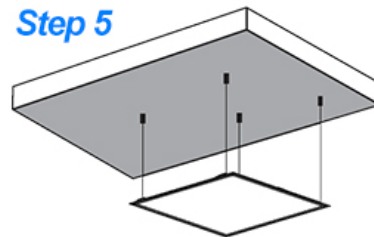

5. Fix the string in the correct place.

Embedded Installation

Step 1

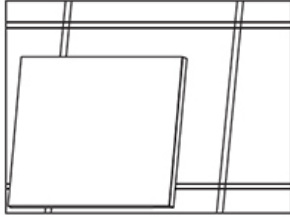

1. Take out the LED panel light.

Step 2

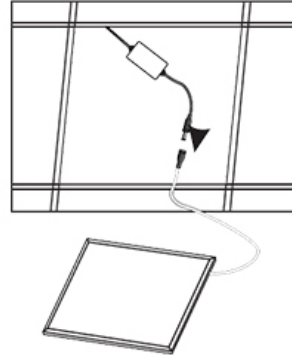

2. Connect the cable and transformer.

Step 3

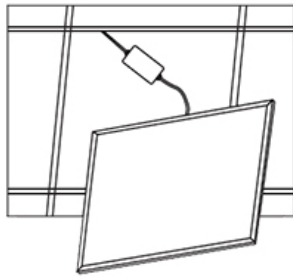

3. Move the light into the place.

Step 4

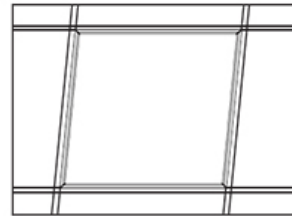

4. Make sure it is secured correctly before use.

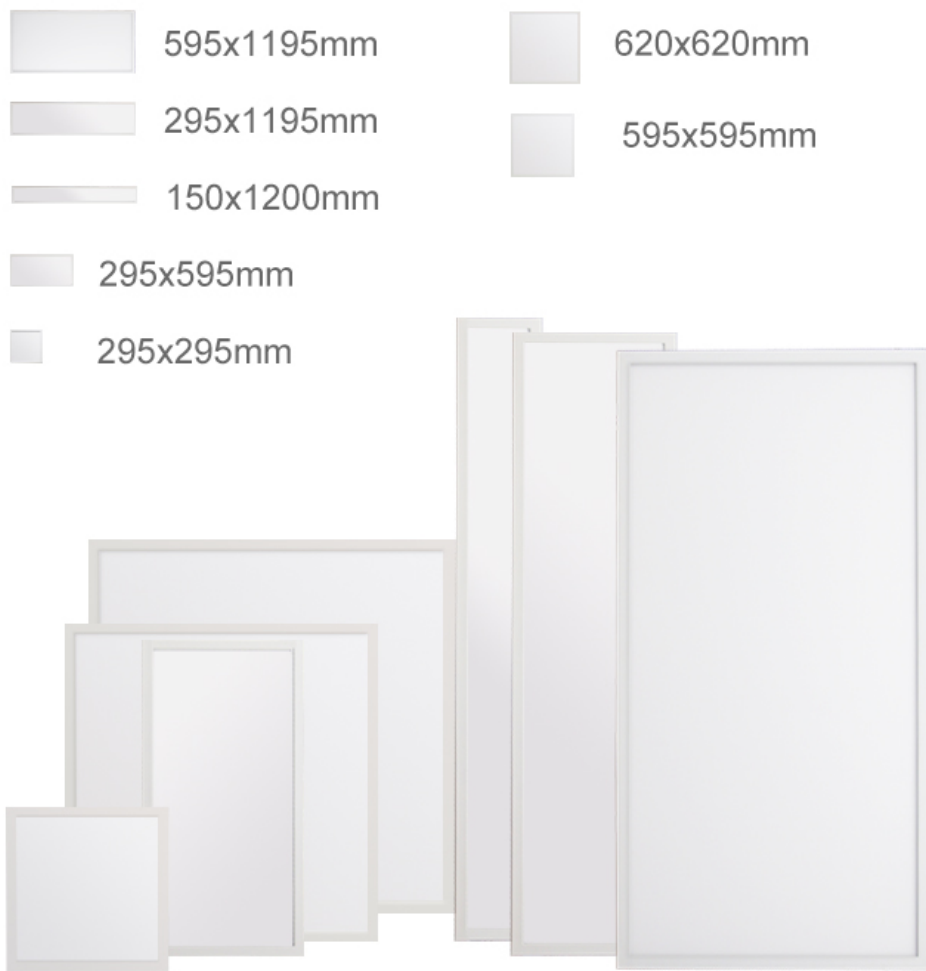

A set of RGB panel:

- ① One panel light
- ② Controller
- ③ Matched Remote Controller
- ④ LED Constant Voltage Driver



Packing

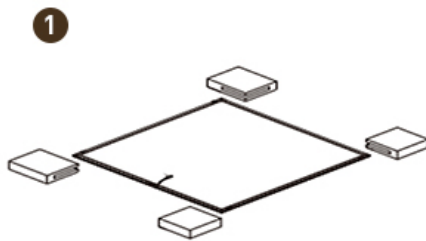

inner box



carton box



