

# CASAMBI

## Presence & Light Sensor

Model: PS02(-L)

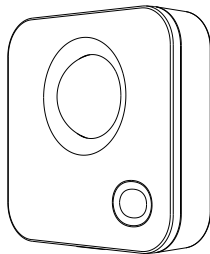

Presence Sense



Light Sense



Multiple Profile



5-year Battery Life

## Function

PS02 is a Casambi enabled presence / light sensor. It can be used as presence or light sensor in Casambi system.

The sensor is powered by battery with two options, the standard model uses CR2032 cell battery and the battery will last for about 1-year for typical application. The PS02-L has a built-in long-life battery which can last for about 5 years, after the built-in battery is out, user can still install CR2032 cell battery to use it as a regular sensor.

The presence sensitivity and light sensor mode can be set from multiple profile options for the sensor, the sensor also can be disabled by easy key-pressing operation.

## Installation



Fig.1 Detection range

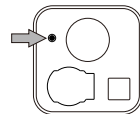

Fig.2 Pairing key

### 1. Presence detection range

The sensor can detect human moving in a cone shape within 2 to 8 meters distance and 120-degree width (Fig.1). The detection sensitivity is adjustable with 3 levels by changing profile from Casambi app for unpaired unit.

### 2. Pair or disable

The sensor needs to be paired to Casambi project before proper working. To pair the sensor, please open the top cover of the sensor and briefly press the pairing key(Fig.2), then discover the sensor and setup from Casambi app.

To disable the sensor, please hold press this key for more than 1 second. After disabled, the sensor will be deactivated for all function until pressing this key again. The battery life will also be extended after disabling.

### 3. Built-in long life battery (-L model)

Besides the main CR2032 cell battery socket, the PS02-L model has a factory built-in long life battery. PS02-L can work for around 5 years without the main battery. After the built-in battery runs out, user still can install the main CR2032 battery for normal operation and get average battery life time around 1 year.

### 4. Adjust features by changing profile

The human detection sensitivity and light sensing mode can be adjusted by changing profile from Casambi app for unpaired sensor.

To change the profile, user will need to press the pairing key on unpaired sensor first, then find the sensor on Casambi app and select 'Change profile' function from the pop-up manual of the sensor. (Fig.3)

### 5. Adjust human detection sensitivity

The human detection sensitivity can be selected from low, middle and high level from the profiles (Fig.4). The detection range is about 2 meters for low sensitivity, 4-5 meters for mid and 6-8 meters for high.

### 6. Adjust light sensing mode

The light sensing mode can be set as timely update or only update when presence detection triggered. With the profiles named with -T, the sensor will check the luminance value every 10 seconds and will send messages to other Casambi devices when the luminance value vary more than 20% from last luminance message. For the profiles without '-T' in the name, the sensor will only send out luminance message when presence detection is triggered.

Please be noted the battery life time will be significantly reduced for timed light sensing profiles. Please only used the '-T' profile when necessary.

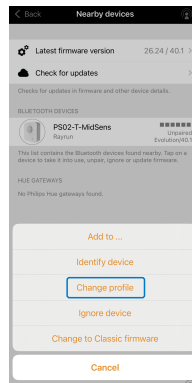

Fig.3

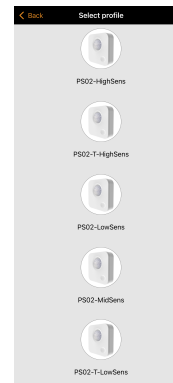

Fig.4

## ■ Specification

Main battery	CR2032 cell battery
Built-in battery	600mAh cell battery, -L model only
Wireless protocol	Casambi protocol
Frequency band	2.4GHz ISM band
Wireless power	< 8dBm
Working temperature	-10-40 °C